

Heat exchanger

Cooltube CT and CT-S Cooling Hose

This cooling hose is designed for flexible laying in existing stainless steel tanks or wooden barrels without a fixed integrated heat exchanger. 2 plug sizes are available.

Features

- ▶ Hose material stainless steel (1.4404), AISI316L, polished surface
 - ▶ Max. operating pressure 4 bar
 - ▶ With silicone fermentation plug
 - ▶ Connections: 3/4" external thread
- Accessories:** Fermentation tube attachment 0° or 45°

Designation	Overall length	Tank size	Order no.	Unit price/€
CT10 / CT10-S	1,000mm	10 hl *)	302.0150 / 302.0165	
CT20 / CT20-S	2,000mm	20 hl *)	302.0151 / 302.0166	
CT30 / CT30-S	3,000mm	30 hl *)	302.0152 / 302.0167	
CT40 / CT40-S	4,000mm	40 hl *)	302.0153 / 302.0168	
CT50 / CT50-S	5,000mm	50 hl *)	302.0154 / 302.0169	
GRA-0	Fermentation siphon 0°		350.0003	
GRA-45	Fermentation siphon 45°		350.0004	

*) Standard situation: Fermentation temperature 18 °C, flow temperature 7 °C, return flow temperature 12 °C



Cooltube CT/CT-S

Technical data for Cooltube

Cooling hose	Type	CT10	CT20	CT30	CT40	CT50
	Order no.	302.0150	302.0151	302.0152	302.0153	302.0154
Plug size: Øtop/ Øbottom/height	mm	60; 50; 45	60; 50; 45	60; 50; 45	60; 50; 45	60; 50; 45
Cooling hose	Type	CT10-S	CT20-S	CT30-S	CT40-S	CT50-S
	Order no.	302.0165	302.0166	302.0167	302.0168	302.0169
Plug size: Øtop/ Øbottom/height	mm	55; 47; 40	55; 47; 40	55; 47; 40	55; 47; 40	55; 47; 40
For tank volumes up to *)	hL	10	20	30	40	50
Overall length L/hose length 2*L	mm	1000 / 2000	2000 / 4000	3000 / 6000	4000 / 8000	5000 / 10000
Nominal diameter	inches	1/2	1/2	1/2	1/2	1/2
Surface	m²	0.18	0.35	0.53	0.70	0.88
Connector pitch	mm	60	60	60	60	60
Pipe thread length 3/4"	mm	12	12	12	12	12

*) Standard situation: Fermentation temperature 18 °C, flow temperature 7 °C, return flow temperature 12 °C

Stainless Steel Cooling Plates HE

High-quality plate heat exchanger for installation in closed wine tanks or use in open vessels.

Features

- ▶ Material 1.4404 (V4A)
- ▶ Connection tube 1/2" with flange disc and thread *)
- ▶ Double welded (roll-seam and WIG welded)
- ▶ Max. operating pressure 4bar
- ▶ Electropolished surface (for improved potassium bitartrate detachment)
- ▶ Design index -G: connections on short side, **fitting from above**
- ▶ Design index -S: connections on long side, **lateral fitting**
- ▶ Suitable for screwing in or welding

Designation	Tank capacity	Dimensions [mm]	L1 [mm]	Tube pitch	Order no.	Unit price/€
HE500-G	3,200 l **)	LxW=500x370	200	200	302.0001	
HE750-G	4,800 l **)	LxW=750x370	200	200	302.0002	
HE1000-G	6,400 l **)	LxW=1,000x370	200	200	302.0003	
HE1250-G	8,000 l **)	LxW=1,250x370	200	200	302.0004	
HE1500-G	9,600 l **)	LxW=1,500x370	200	200	302.0005	
HE1750-G	11,200 l **)	LxW=1,750x370	200	200	302.0006	
HE2000-G	12,800 l **)	LxW=2,000x370	200	200	302.0007	
HE2500-G	16,000 l **)	LxW=2,500x370	200	200	302.0008	
HE3000-G	19,200 l **)	LxW=3,000x370	200	200	302.0009	

*) Tube connection cross section 1/2" suitable for tanks up to 30,000 litres

**) Standard situation: Fermentation temperature 18°C, flow temperature 7°C, return flow temperature 12°C

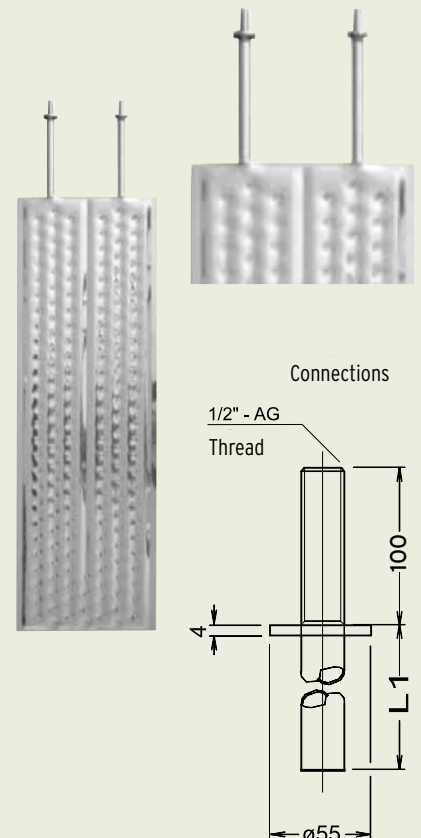

Cooling Technology

Designation	Tank capacity	Dimensions [mm]	L1 [mm]	Order no.	Unit price/€
HE500-S	3,200 l (**)	LxW=500x370	56	302.0029	
HE750-S	4,800 l (**)	LxW=750x370	56	302.0030	
HE1000-S	6,400 l (**)	LxW=1,000x370	56	302.0031	
HE1250-S	8,000 l (**)	LxW=1,250x370	56	302.0032	
HE1500-S	9,600 l (**)	LxW=1,500x370	56	302.0033	
HE1750-S	11,200 l (**)	LxW=1,750x370	56	302.0034	
HE2000-S	12,800 l (**)	LxW=2,000x370	56	302.0035	
HE2500-S	16,000 l (**)	LxW=2,500x370	56	302.0036	
HE3000-S	19,200 l (**)	LxW=3,000x370	56	302.0037	

Designation	Tank capacity	Dimensions [mm]	L1 [mm]	Order no.	Unit price/€
HE250-150-S	650 l (**)	LxW=250x150	56	302.0089	
HE500-150-S	1,300 l (**)	LxW=500x150	56	302.0090	
HE750-150-S	1,950 l (**)	LxW=750x150	56	302.0091	
HE1000-150-S	2,600 l (**)	LxW=1,000x150	56	302.0092	
HE1250-150-S	3,200 l (**)	LxW=1,250x150	56	302.0093	
HE1500-150-S	3,850 l (**)	LxW=1,500x150	56	302.0094	

Accessories

Designation	Details	Order no.	Unit price/€
BS-1/2	Fixing kit: 2 nuts, 2 washers, 2 food-safe seals	304.9000	
AS-1/2	Compensation kit: 8 PTFE wedges, 6 food-safe seals	304.9001	

*) Tube connection cross section 1/2" suitable for tanks up to 30,000 litres

**) Standard situation: Fermentation temperature 18 °C, flow temperature 7 °C, return flow temperature 12 °C

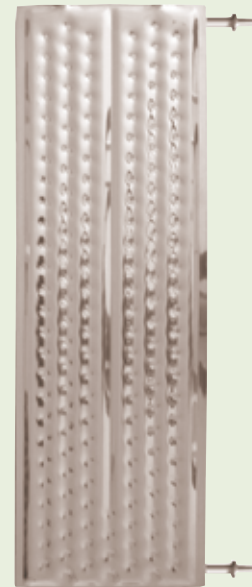

Connections

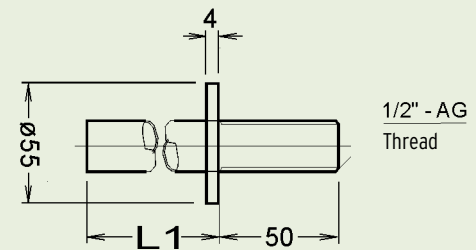

Stainless Steel Cooling Plates Size Selection

Plate length per 1,000 litres must (fermentation cooling only)

Applies for plate width 370mm

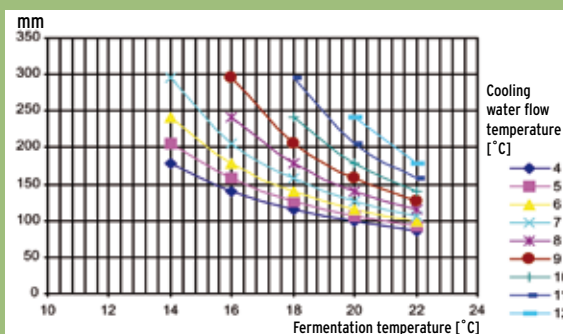

Tube Cooler for Bunghole Valve RK

Tube heat exchanger for system integration in a standardised bunghole valve on beverage containers.

Features

- Material: Stainless steel (1.4301), AISI304, polished
- With tube diameter/material thickness: 36 mm / 2 mm
- Direct fit for standard bunghole valve K/M Gr. 37
- Max. operating pressure 6 bar, test pressure 10 bar

Designation	Details	L [mm]	d [mm]	Inlet	Outlet	Order no.	Unit price/€
RK6	Tube heat exchanger	600	36.0	IT 1/2"	IT 1/2"	302.0195	
RK8	Tube heat exchanger	800	36.0	IT 1/2"	IT 1/2"	302.0193	
RK10	Tube heat exchanger	1,000	36.0	IT 1/2"	IT 1/2"	302.0191	
RK12	Tube heat exchanger	1,200	36.0	IT 1/2"	IT 1/2"	302.0192	
RK14	Tube heat exchanger	1,400	36.0	IT 1/2"	IT 1/2"	302.0194	

