

Heat exchanger

Cooltube CT Cooling Hose

This cooling hose is designed for flexible laying in existing stainless steel tanks or wooden barrels without a fixed integrated heat exchanger.

Features

- ▶ Hose material stainless steel (1.4404), AISI316L, polished surface
 - ▶ Max. operating pressure 4 bar
 - ▶ With silicone fermentation plug
 - ▶ Connections: 3/4" external thread
- Accessories:** Fermentation tube attachment 0° or 45°

Designation	Overall length	Tank size	Order no.	Unit price/€
CT10	1,000 mm	10 hl *)	302.0150	
CT20	2,000 mm	20 hl *)	302.0151	
CT30	3,000 mm	30 hl *)	302.0152	
CT40	4,000 mm	40 hl *)	302.0153	
CT50	5,000 mm	50 hl *)	302.0154	
GRA-0 fermentation tube attachment 0°			350.0003	
GRA-45 fermentation tube attachment 45°			350.0004	

*) Standard situation: Fermentation temperature 18 °C, flow temperature 7 °C, return flow temperature 12 °C



Cooltube cooling hose technical data

Cooling hose	Type	CT10	CT20	CT30	CT40	CT50
	Order no.	302.0150	302.0151	302.0152	302.0153	302.0154
For tank volumes up to *)	hl	10	20	30	40	50
Overall length L	mm	1,000	2,000	3,000	4,000	5,000
Overall hose length 2xL	mm	2,000	4,000	6,000	8,000	10,000
Nom. diameter	inch	1/2	1/2	1/2	1/2	1/2
Surface	m ²	0.18	0.35	0.53	0.70	0.88
Connection pitch	mm	60	60	60	60	60
Pipe thread length 3/4"	mm	12	12	12	12	12
Fermentation plug size: Øtop; Øbottom; height	mm	60; 50; 45	60; 50; 45	60; 50; 45	60; 50; 45	60; 50; 45

*) Standard situation: Fermentation temperature 18 °C, flow temperature 7 °C, return flow temperature 12 °C

Stainless Steel Cooling Plates HE

High-quality plate heat exchanger for installation in closed wine tanks or use in open vessels.

Features

- ▶ Material 1.4404 (V4A)
- ▶ Connection tube 1/2" with flange disc and thread *)
- ▶ Double welded (roll-seam and WIG welded)
- ▶ Max. operating pressure 4bar
- ▶ Electropolished surface (for improved potassium bitartrate detachment)
- ▶ Design index -G: connections on short side, **fitting from above**
- ▶ Design index -S: connections on long side, **lateral fitting**
- ▶ Suitable for screwing in or welding

Designation	Tank capacity	Dimensions [mm]	L1 [mm]	Tube pitch (centre-centre) [mm]	Order no.	Unit price/€
HE500-G	3,200 l. **)	LxW=500x370	200	200	302.0001	
HE750-G	4,800 l. **)	LxW=750x370	200	200	302.0002	
HE1000-G	6,400 l. **)	LxW=1,000x370	200	200	302.0003	
HE1250-G	8,000 l. **)	LxW=1,250x370	200	200	302.0004	
HE1500-G	9,600 l. **)	LxW=1,500x370	200	200	302.0005	
HE1750-G	11,200 l. **)	LxW=1,750x370	200	200	302.0006	
HE2000-G	12,800 l. **)	LxW=2,000x370	200	200	302.0007	
HE2500-G	16,000 l. **)	LxW=2,500x370	200	200	302.0008	
HE3000-G	19,200 l. **)	LxW=3,000x370	200	200	302.0009	

*) Tube connection cross section 1/2" suitable for tanks up to 30,000 litres

**) Standard situation: Fermentation temperature 18 °C, flow temperature 7 °C, return flow temperature 12 °C

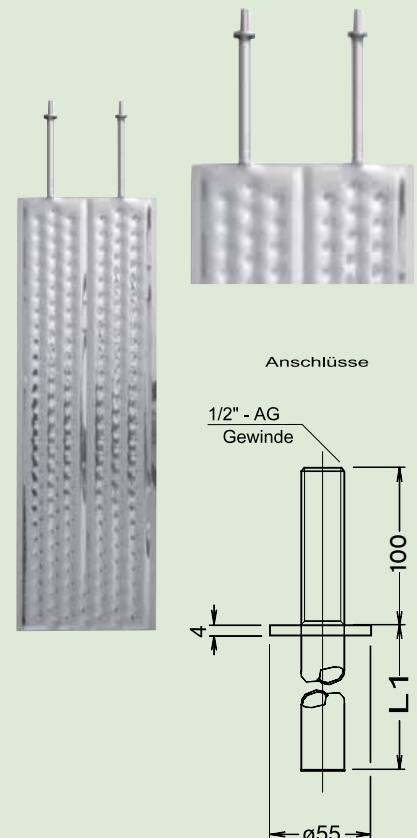

Cooling Technology

Designation	Tank capacity	Dimensions [mm]	L1 [mm]	Order no.	Unit price/€
HE500-S	3,200 l. **)	LxW=500x370	56	302.0029	
HE750-S	4,800 l. **)	LxW=750x370	56	302.0030	
HE1000-S	6,400 l. **)	LxW=1,000x370	56	302.0031	
HE1250-S	8,000 l. **)	LxW=1,250x370	56	302.0032	
HE1500-S	9,600 l. **)	LxW=1,500x370	56	302.0033	
HE1750-S	11,200 l. **)	LxW=1,750x370	56	302.0034	
HE2000-S	12,800 l. **)	LxW=2,000x370	56 </tr		

Designation	Tank capacity	Dimensions [mm]	L1 [mm]	Order no.	Unit price/€
HE250-150-S	650 l. **)	LxW=250x150	56	302.0089	
HE500-150-S	1,300 l. **)	LxW=500x150	56	302.0090	
HE750-150-S	1,950 l. **)	LxW=750x150	56	302.0091	
HE1000-150-S	2,600 l. **)	LxW=1,000x150	56	302.0092	
HE1250-150-S	3,200 l. **)	LxW=1,250x150	56	302.0093	
HE1500-150-S	3,850 l. **)	LxW=1,500x150	56	302.0094	

Accessories

Designation	Details	Order no.	Unit price/€
BS-1/2	Fixing kit: 2 nuts, 2 washers, 2 food-safe seals	304.9000	
AS-1/2	Compensation kit: 8 PTFE wedges, 6 food-safe seals	304.9001	

*) Tube connection cross section 1/2" suitable for tanks up to 30,000 litres

**) Standard situation: Fermentation temperature 18 °C, flow temperature 7 °C, return flow temperature 12 °C

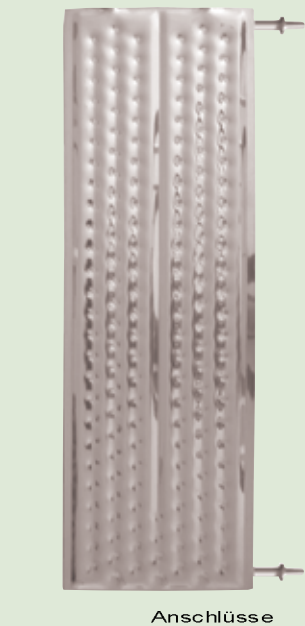

Anschlüsse

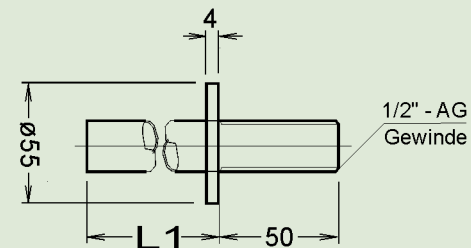

Stainless Steel Cooling Plates Size Selection

Plate length per 1,000 litres must (fermentation cooling only)

Applies for plate width 370 mm

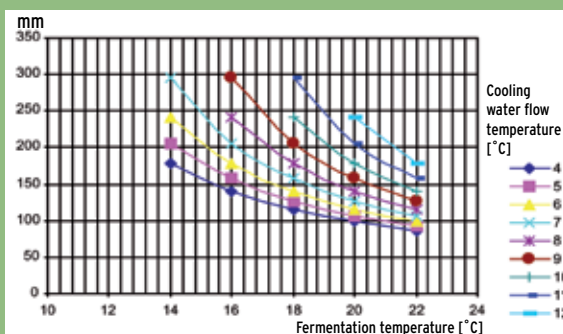

Tube Cooler for Bunghole Valve RK

Tube heat exchanger for system integration in a standardised bunghole valve on beverage containers.

Features

- Material: stainless steel (1.4301, AISI304), polished surface
- Direct fit for standard bunghole valve K/M Gr. 37
- With tube diameter/material thickness: 36 mm / 2 mm
- Max. operating pressure 6 bar, test pressure 10 bar

Designation	Details	L [mm]	d [mm]	Inlet	Outlet	Order no.	Unit price/€
RK8	Tube heat exchanger	800	36.0	IT 1/2"	IT 1/2"	302.0193	
RK10	Tube heat exchanger	1,000	36.0	IT 1/2"	IT 1/2"	302.0191	
RK12	Tube heat exchanger	1,200	36.0	IT 1/2"	IT 1/2"	302.0192	
RK14	Tube heat exchanger	1,400	36.0	IT 1/2"	IT 1/2"	302.0194	

